

SEAT ADAPTER KIT #88367 INSTALLATION INSTRUCTIONS



#6238-00 10-21

ALL SPECIFICATIONS ARE SUBJECT TO CHANGE WITHOUT NOTICE

ROADMASTER, Inc. 6110 NE 127th Ave. Vancouver, WA 98682 360-896-0407 fax 360-735-9300 www.roadmasterinc.com

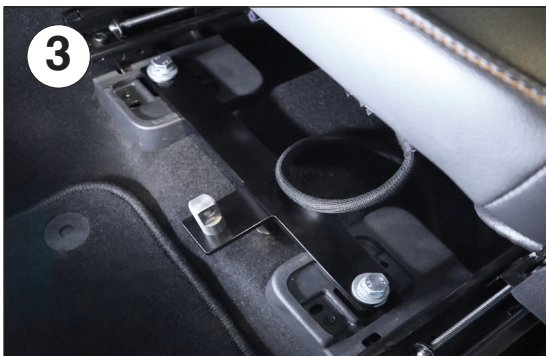
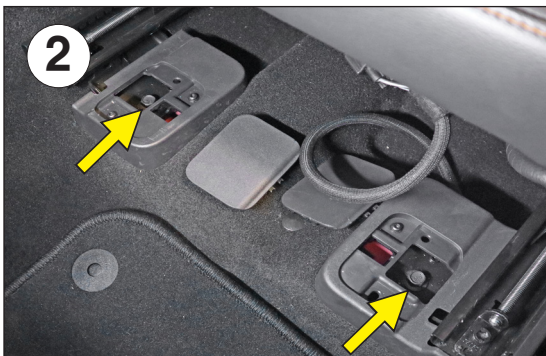
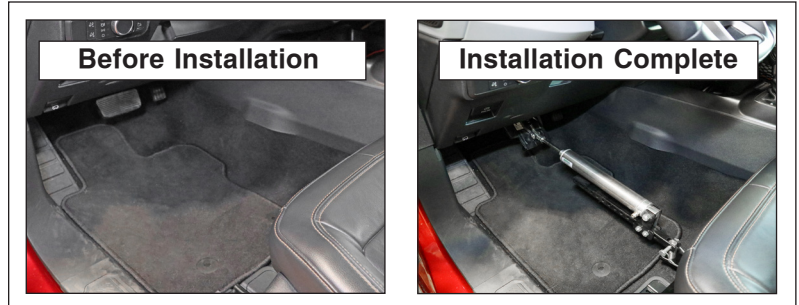

Instructions

1. Push the driver's seat back as far as possible. Carefully remove the seat track covers (Fig.1). Then, remove two 13mm bolts attaching the seat track to the floor pan (Fig.2). The covers and bolts will not be replaced.
2. Place a 1" O.D. x .188 wall x 1-1/8" pipe spacer over each hole and then place the seat adapter (with the tab facing down) over the pipe spacers. Use the supplied M10 x 1.5 x 60mm bolts, M10 lock washers and M10 flat washers and bolt down through the seat adapter, pipe spacer and into the floor pan for each mount (Fig.3).
3. Attach the BrakeMaster to the brake pedal and to the seat adapter. Adjust the length of the air cylinder assembly per the BrakeMaster installation instructions, ensuring that the BrakeMaster is pulling back on the brake pedal so the pedal is only depressed when the brakes are engaged at the motorhome. Failure to adjust the assembled length of the BrakeMaster may result in severe brake system damage and/or complete failure of the brakes.

Parts List

- (1) 3/8" x 3/4" bolt
- (1) 3/8" lock washer
- (2) M10 lock washers
- (2) M10 flat washers
- (2) M10 x 1.5 x 60mm bolts
- (2) 1" O.D. x .188 wall x 1-1/8" pipe spacers

IMPORTANT

Once the seat adapter has been installed, carefully run the seat through its full range of motion. If it is impeded in any way, immediately stop and correct the interference. Failure to do so may result in non-warranty property damage.



WARNING

Failure to follow these instructions can result in property damage, personal injury or even death.