



Steering Stabilizer INSTALLATION INSTRUCTIONS

KIT# RBK18

10/25
RS

ROADMASTER, Inc. 6110 NE 127th Ave. Vancouver, WA 98682 360-896-0407 www.RoadmasterInc.com

For Class "A" RV's

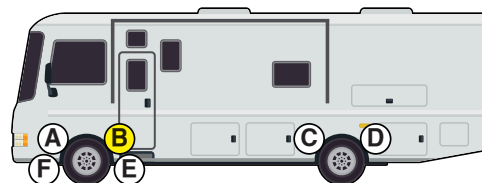

WARNING

Failure to follow these instructions can result in property damage, personal injury or even death.

- The installer must read the instructions and use all bolts and parts supplied. Failure to securely fasten the stabilizer could result in loss of the stabilizer, damage to the vehicle, personal injury or even death.
- There must be adequate clearance between the Steering Stabilizer and all chassis and steering parts, and any other components, or non-warranty damage to the vehicle will result. After final installation, the installer must inspect the stabilizer to ensure adequate clearance. Some minor adjustments may be needed to achieve this; always verify that the steering wheel remains centered before and after these adjustments.
- Always test drive the vehicle to confirm the steering wheel settings. If the vehicle pulls to either side, the center positioning must be adjusted. If the steering wheel does not return to the center position, the tie rod bracket may require minor adjustments. Failure to adjust the center positioning may result in a loss of vehicular control.
- After installing this Steering Stabilizer, any technician who is performing alignment or suspension work on the motorhome must loosen the tie-rod bracket to adjust the toe; the technician must also re-adjust the steering damper. Failure to adjust the center positioning may result in a loss of vehicular control.
- Regardless of year, make and model, a wide range of options for specific applications may or may not interfere with the installation. It is the

installer's responsibility to make certain that equipment is not damaged once the suspension solution travels through the full range of motion. Failure to ensure adequate clearance could result in non-warranty property damage, personal injury or even death.

- If running changes were made by the vehicle manufacturer after this kit was designed, some bolts or other fasteners in the included hardware pack may no longer be the correct size. It is the installer's responsibility to verify that the stabilizer is securely fastened to the vehicle, and fitted with the correct hardware, to account for these changes. Failure to securely fasten the stabilizer could result in loss of the stabilizer, damage to the vehicle, personal injury or even death.
- Except to adjust for running changes to the vehicle, use only the parts supplied by ROADMASTER to install the stabilizer. Using substandard grade parts or parts of the wrong size may result in loss of the stabilizer, damage to the vehicle, personal injury or even death.
- Once a year, the owner must inspect the fasteners for proper tightness and/or torque, according to the bolt torque requirements chart in these instructions. Failure to securely fasten the stabilizer could result in loss of the stabilizer, damage to the vehicle, personal injury or even death.
- Do not use an air impact wrench when reinstalling bolts, as stripped threads may result.
- This stabilizer is only warranted for the original installation. Installing a used stabilizer on another vehicle is not recommended and will void the warranty.



Information:

Thank you for purchasing this steering stabilizer kit. This kit is designed to improve the handling characteristics of the motorhome.

The kit is engineered for long life and trouble-free performance. All the hardware needed for installation is included in this kit. Refer to the *PARTS LIST* in these instructions to identify the parts.

Before starting the installation, lay out the kit components in order, as they will be used. This will give you a visual idea of how the components work, and will also confirm that everything is present and accounted for.

BOLT TORQUE REQUIREMENTS

Note: The torque values represented below are intended as general guidelines. Torque requirements for specific applications may vary. Roadmaster does not warrant this information to be accurate for all applications and disclaims all liability for any claims or damages which may result from its use.

STANDARD BOLTS

Thread Size	Grade	Torque
5/16-18	5	13 ft./lb.
3/8-16	5	23 ft./lb.
7/16-14	5	37 ft./lb.
1/2-13	5	57 ft./lb.
5/8-11	5	112 ft./lb.

METRIC BOLTS

Thread Size	Grade	Torque
6mm-1.0	8.8	6 ft./lb.
8mm-1.0	8.8	18 ft./lb.
8mm-1.25	8.8	16 ft./lb.
10mm-1.25	8.8	36 ft./lb.
10mm-1.5	8.8	31 ft./lb.

METRIC BOLTS

Thread Size	Grade	Torque
12mm-1.25	8.8	64 ft./lb.
12mm-1.5	8.8	60 ft./lb.
12mm-1.75	8.8	55 ft./lb.
14mm-2.0	8.8	88 ft./lb.



Steering Stabilizer INSTALLATION INSTRUCTIONS

KIT# RBK18

10/25
RS

ROADMASTER, Inc. 6110 NE 127th Ave. Vancouver, WA 98682 360-896-0407 www.RoadmasterInc.com

What You'll Need

Sockets and Wrench
General Hand tools
Jack Stands
Second Person to Help

About this kit

For Some Class A RVs

Need Help? Call Toll-Free
 1-800-669-9690

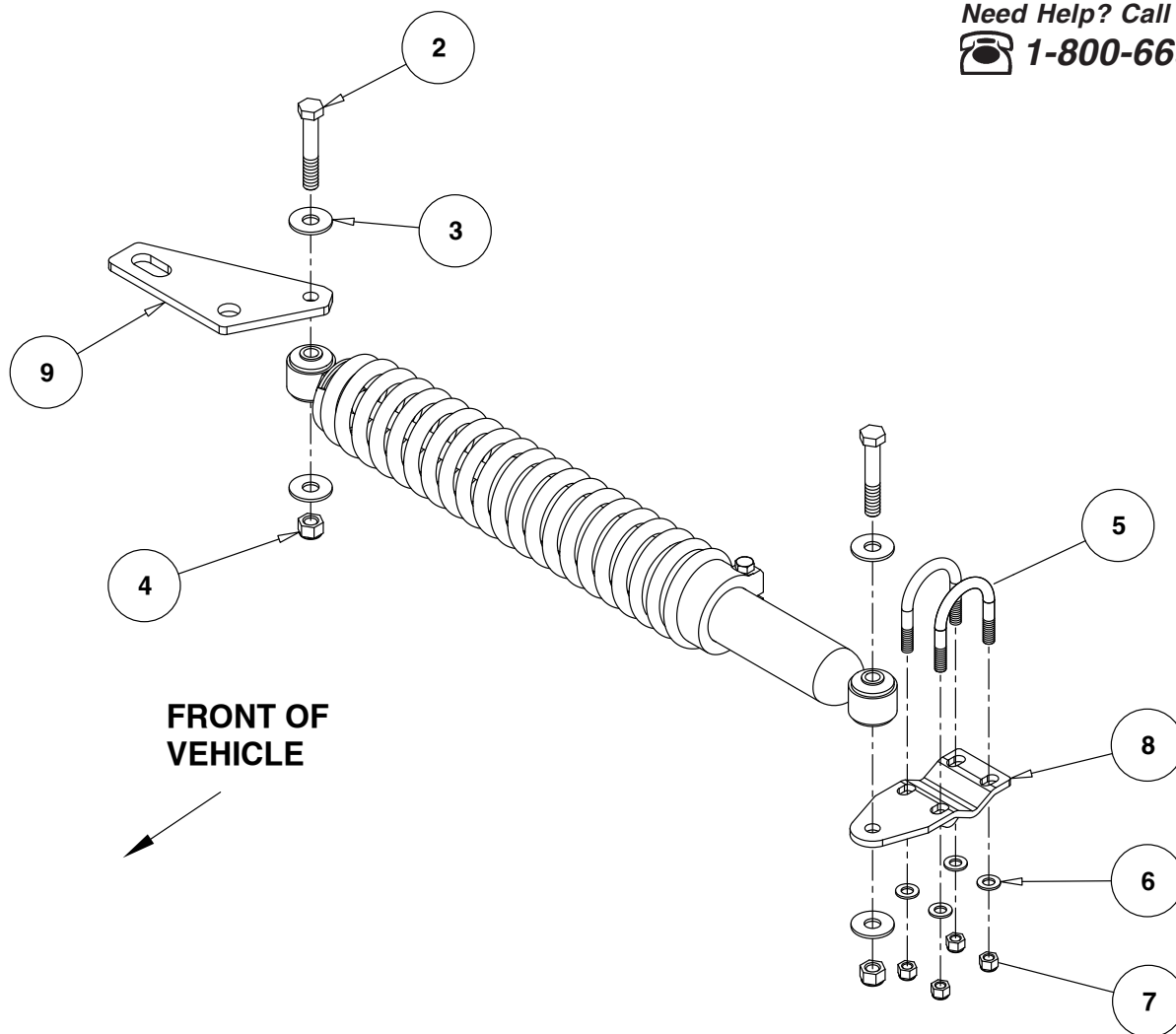

ITEM	QTY	DESCRIPTION	PART
1	1	THREADLOCKER	200544-00
2	2	1/2" x 3" BOLT	350101-50
3	4	1/2" FLAT WASHER	350308-00
4	2	1/2" NYLON INSERT LOCK NUT	350259-01
5	2	3/8" UBOLT	LRG38
6	4	M10 FLAT WASHER	355710-00
7	4	3/8" NYLON INSERT LOCK NUT	350255-00
8	1	TIE-ROD BRACKET	B802
9	1	AXLE BRACKET	B1172

Important: All illustrations and specifications contained herein are based on the latest information available at the time of publication approval. ROADMASTER, INC. reserves the right to make changes at any time without notice in material, specification and models or to discontinue models.



Steering Stabilizer INSTALLATION INSTRUCTIONS

KIT# RBK18

10/25
RS

ROADMASTER, Inc. 6110 NE 127th Ave. Vancouver, WA 98682 360-896-0407 www.RoadmasterInc.com

Installation:

Note: Roadmaster makes multiple steering stabilizers. The unit depicted in these instructions may vary from your unit but almost all stabilizers will follow these instructions. If installing a Reflex, ensure that the spring is fully-seated in its track on the collar of the unit. If it is installed without the spring fully-seated in its track, the unit could malfunction or otherwise fail to operate properly (Fig.B).

1. Before installing the steering stabilizer, inspect the drag link and tie rod ends, as well as the steering components. If they are excessively worn and/or have excessive play, they will cause handling problems that the steering stabilizer will not fix. Replace worn components before installing the stabilizer to achieve the best results. *Note: the coach must be at normal ride height for proper installation. Center the steering wheel and lock it into place.*

2. Mount the B1172 Bracket onto the passenger side of the vehicle behind the axle by removing the back two nuts of the axle OEM u-bolt, then placing the bracket onto the u-bolt, placing a washer with nuts on bottom (Fig.C). Torque bolts and nuts to proper specification.

3. Install the B802E Tie Rod Bracket by placing the indentation on the top of the tie rod with the 9/16" mounting hole facing the front of the motorhome. The bracket will be parallel to the ground. Using the two provided 3/8" u-bolts, washers, and lock nuts, loosely clamp the tie rod bracket to the tie rod proper (Fig.D). Torque the hardware as specified in page 2.

4. Then, install the Reflex Stabilizer to the brackets; place one mounting bolt through the chassis bracket with the threads facing down. Once that is done, place one 1/2" washer on both sides of the stabilizer mounting loop nearest to the aluminum casting and place it onto the mounting bolt. Secure the end with a lock nut.

5. Adjust the tie rod bracket so that the Reflex Stabilizer unit is in a level position and then tighten the respective u-bolt locknuts and all bracket nuts to proper specification.

6. Test drive the vehicle to make certain that the Reflex stabilizer is adjusted properly. If the steering pulls to either side, center it by loosening the bracket U-bolts at the tie rod, and then reposition it. Tighten the bolts and test drive it once again, repeating the process until the proper adjustment is achieved.

Fig.B



Fig.C



Fig.D



⚠ WARNING

The Reflex Stabilizer is not, nor any brackets are, a load-bearing component!

Do not tow or hoist the vehicle using the any of the added parts or their mounting brackets as attachment points. The parts are not designed to carry the weight of the vehicle and may collapse, which will damage the components, the suspension, or other vehicle components. The vehicle will detach or fall, which may cause severe personal injury.

Failure to follow the instructions in this packet and the warnings therein may result in property damage, personal injury or even death.