



# Installation Instructions

Thank you for purchasing this anti-sway bar kit. Please read through these instructions before installation.

## Rear Anti-Sway Bar Kit for Workhorse W16/18

part #1259-118  
1-1/2" diameter



### INTRODUCTION

Thank you for purchasing this anti-sway bar kit. This kit is designed to improve the handling characteristics of your motorhome by reducing the body roll and balancing the weight transfer during cornering. The anti-sway bar kit is engineered for long life and trouble-free performance.

All the hardware needed for installation is included in this kit. Refer to the PARTS LIST in these instructions to identify the parts.

### SUGGESTED TOOLS

The following tools are suggested to complete the installation procedures:

- General hand tools
- Torque wrench
- Drill bits: 1/4", 1/2"
- Sockets: 5/8", 11/16", 3/4", 15/16", 1-1/8"
- Drill Motor
- Wrenches: 5/8", 11/16", 3/4", 15/16"

### WARNING

**Failure to follow these instructions can result in property damage, personal injury or even death.**

- If raising the vehicle to install the anti-sway bar, always support the vehicle with jack stands at both frame rails or at the rear axle before working underneath. Ensure that the jack stands are securely positioned, and are rated at or above the weight of the vehicle.
- The installer must read the instructions and use all bolts and parts supplied. Use only the parts supplied by ROADMASTER to install this kit.
- Minor modifications are sometimes necessary due to slight vehicle variations, even for the same year, make and model.
- Regardless of year, make and model, a wide range of options for specific applications may or may not interfere with the installation. It is the installer's responsibility to make certain that equipment is not damaged once the suspension solution travels through the full range of motion. Failure to ensure adequate clearance could result in non-warranty property damage, personal injury or even death.
- If running changes were made by the manufacturer after this kit was designed, there may be weldments, braces, gussets, or other structural items which interfere with the installation. It is the installer's responsibility to allow for these running changes without sacrificing the structural integrity of the anti-sway bar. Failure to securely fasten the anti-sway bar could result in property damage, personal injury or even death.
- ROADMASTER will not be responsible for any damage or injury resulting from any modification or alteration.
- Check ALL the fasteners for tightness before and after road testing the vehicle.
- Do not use this document for custom fabrication, as it may not show all parts or structural components.
- Do not use an air impact wrench when re-installing bolts, as stripped threads may result.
- This anti-sway bar is only warranted for the original installation. Installing a used anti-sway bar on another vehicle is not recommended and will void the warranty.

# PARTS LIST

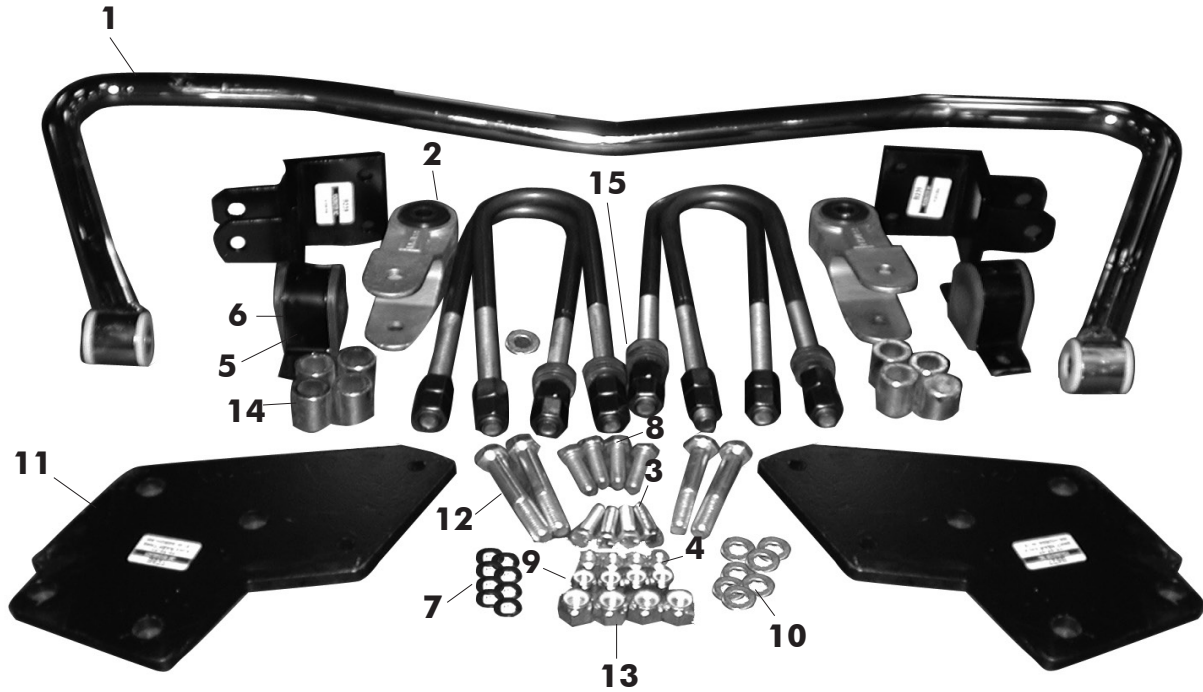

## Part #1259-118

Part #	Description	Qty
1.	580024-00 Anti-sway bar, 1-1/2"	1
2.	B209 Shackle assembly	2
3.	350074-00 Bolt, 7/16" x 1-1/2"	4
4.	350256-02 Locknut, 7/16"	4
5.	B141 Bracket, u-clamp	2
6.	205217-10 Bushing, split poly	2
7.	350304-80 Washer, 3/8"	8
8.	350096-80 Bolt, 1/2" x 1-3/4"	4
9.	350259-00 Locknut, 1/2"	4

Part #	Description	Qty
10.	350308-20 Washer, 1/2"	8
11.	B527 Bracket, flat	2
12.	350158-00 Bolt, 5/8"	4
13.	350263-00 Nut, 5/8"	4
14.	B549 Spacer	8
15.	357428-00 U-bolt assembly	4
16.	400011-30* AQUALUBE Grease	1
17.	205503-00* Sleeve	2
18.	205209-00* Poly bushing	4

\* Not pictured

# INSTALLATION

The following instructions must be followed in the order listed to ensure a proper installation and to preserve the ROADMASTER warranty.

1. Remove the parts from the box and match it with the parts list.

Make sure that the kit has all the parts shown on the parts list page.

2. Apply the parking brake. Block the front and rear wheels.
3. Substitute the longer u-bolts and install the mounting plates.

Remove the nuts from the u-bolts on the driver's side. Remove each u-bolt and replace with part 357428-00. Reinstall the factory axle/shock plate and install the washers and adaptor nuts (B524) in this order: washer, nut, plate and nut. Torque to 175-200ft.-lbs. Now, install the mounting plate (B527) with the small holes in the plate toward the front and center of the chassis. Torque to 175-200 ft./lbs. Repeat this process on the passenger side (Figure 1, 2).

4. Install the saddle brackets and bushings on the anti-sway bar.

Lubricate the inside of the split bushings with the provided lubricant (Figure 4). Install the bushings on the anti-sway bar near the arms. Slide the saddle brackets over the split bushings.

5. Install the anti-sway bar assembly to the flat plates.

Lift the anti-sway bar assembly into position so that the saddle bracket holes align with the flat plate holes. Use the provided bolts (350074-00), washers (350304-80) and nuts (350256-02) to attach. Tighten securely to 35-45 ft.-lbs. (Figure 2, 3).

**Figure 1**



**Figure 2**



**Figure 3**



## BOLT TORQUE REQUIREMENTS

STANDARD BOLTS			U-BOLTS	
Thread	Grade	Torque	Thread	Torque
3/8.....	5.....	30 lb-ft	3/8-24 .....	35 lb-ft
7/16.....	5.....	50 lb-ft	1/2-20 .....	70 lb-ft
1/2.....	5.....	75 lb-ft	5/8-18 .....	140 lb-ft
5/8.....	5.....	140 lb-ft	3/4-16 .....	250 lb-ft
			7/8-14 .....	400 lb-ft

**Note:** Endlink bolts use grommets and should NOT be torqued. Tighten these bolts by hand until the grommet starts to deform. Also, these torque values are intended as general guidelines. Roadmaster does not warrant this information to be accurate for all applications and disclaims all liability for any claims or damages which may result from its use.

# INSTALLATION

6. Locate the shackles and fasteners.

Attach shackle B209 to the anti-sway bar end with the provided bolts (350158-00) and nuts (350263-00). Do not tighten yet.

7. Attach the frame brackets to the shackles.

Attach the frame brackets to the shackle using the provided hardware. Do not tighten yet.

8. Locate provided shackle hanger brackets.

Place the frame bracket against the frame rail. The location is correct when the shackle is straight up and down. Clamp the bracket in place and mark the mounting holes. Drill a pilot hole and then, finally, a 1/2" hole in frame (Figure 4,5).

*Note:* check inside the frame rail for lines, wires, etc. before drilling. Brackets can be switched side to side if necessary.

Fasten with provided bolt (350096-80), washer (350308-20) and nut (350259-00) in both holes. Tighten fasteners 55-65 ft.-lbs.

9. Tighten all nuts and bolts.

Tighten both the upper and lower shackle bolts to 30-45 ft.-lbs. Recheck all fasteners for proper torque.

10. Test drive and reinspect the installation.

Listen for any unusual noises.

**Figure 4**



**Figure 5**



## **WARNING**

After road testing, re-check all fasteners for proper tightness — if a fastener has worked loose or fallen off, re-tighten or replace it. Without all kit components properly tightened or in place, the anti-sway bar will not stabilize the vehicle at full capacity, which may cause reduced cornering ability or other reductions in vehicle handling or performance.

Failure to follow these instructions may result in property damage, personal injury or even death.

## **WARNING**

### **The anti-sway bar is not a load-bearing component**

Do not tow or hoist the vehicle using the anti-sway bar or its mounting brackets as attachment points. The anti-sway bar is not designed to carry the weight of the vehicle and may collapse, which will damage the anti-sway bar components, the suspension, or other components. The vehicle will detach or fall, which may cause severe personal injury.

Failure to follow these instructions may result in property damage, personal injury or even death.