



# BASEPLATE KIT INSTALLATION INSTRUCTIONS

**KIT# 1409-3**

 10/20/11  
KS

ROADMASTER, Inc. 6110 NE 127th Ave. Vancouver, WA 98682 1-800-669-9690 fax 360-735-9300 www.roadmasterinc.com

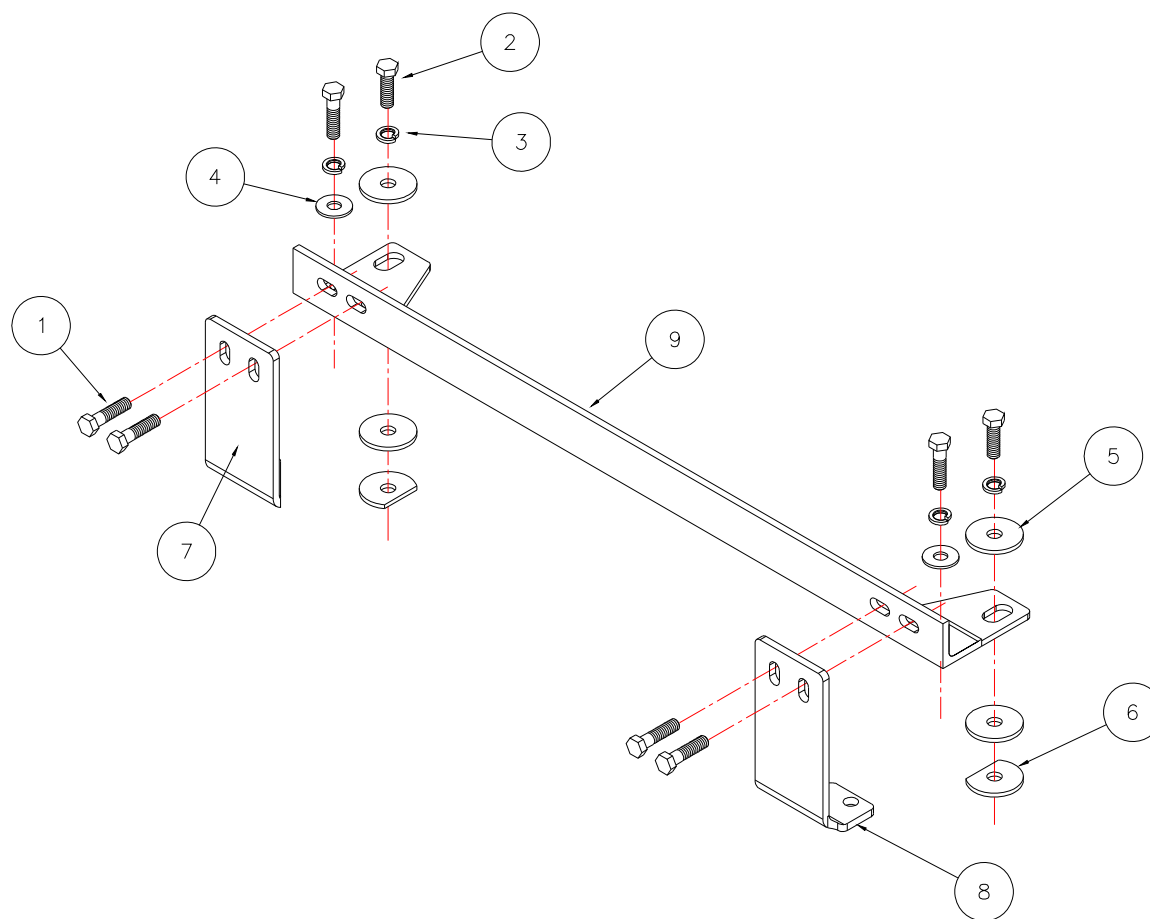

Item	Qty	Length	Width	Name	Part No.
1	6	2"	1/2"	1/2" x 2" BOLT	350097-00
2	2	1 3/4"	1/2"	1/2" x 1 3/4" BOLT	350096-00
3	8		1/2"	1/2" LOCK WASHER	350309-00
4	4		1/2"	1/2" FLAT WASHER	350308-00
5	4		1/2"	1/2" PLATE WASHER	100027-00
6	2		1/2"	1/2" CLIPPED PLATE WASHER	A-002687
7	1	8 3/4"	4"	PASS. SIDE LOWER BRACE	B-000332
8	1	8 3/4"	4"	DRIVER SIDE LOWER BRACE	B-000331
9	1	33 1/2"	2"	MAIN BRACE	C-000466



# BASEPLATE KIT INSTALLATION INSTRUCTIONS

**KIT# 1409-3**

10/20/11  
KS

ROADMASTER, Inc. 6110 NE 127th Ave. Vancouver, WA 98682 1-800-669-9690 fax 360-735-9300 www.roadmasterinc.com

This bracket kit is designed as an adaptor to allow the mounting of any of our towing products to the front bumper. The kit consists of two front braces, one main brace and hardware kit (Fig.A).

Before starting the installation, lay out the kit components in order as they will be used. This will give you a visual idea of how the components work, and will also confirm that everything is present and accounted for.

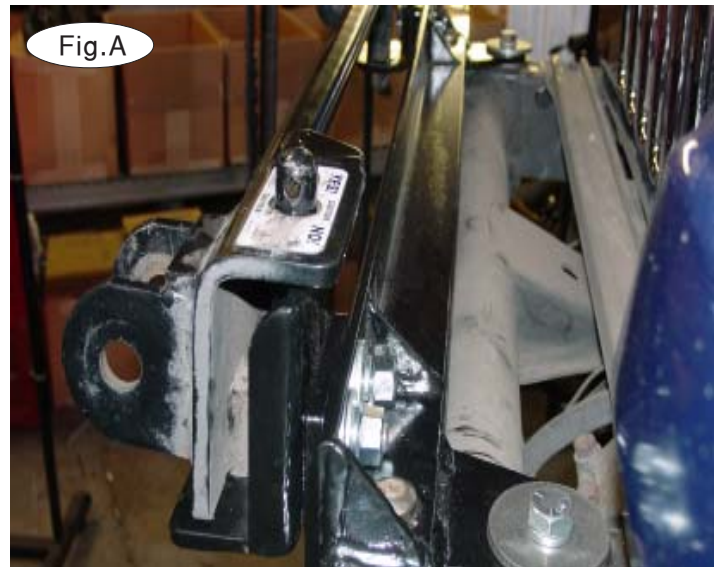

**IMPORTANT:** All baseplates **must** be assembled with all the bolts left loose for final adjustment and positioning (before tightening) unless otherwise instructed. All bolts **must** be torqued for proper strength. If more than one bolt is used per fastening point, the diagram may only show one. Use flat washers over all slotted holes and lock washers on all fasteners.

## WARNING

Failure to heed these warnings or follow the installation instructions may result in a voided warranty, loss of towed vehicle, personal injury or death.

- Do not weld or modify this baseplate or its components. Welding or modification will void the warranty.
- Do not use this document as a basis to design/fabricate a baseplate, as it may not show all parts or structural components.
- We strongly recommend professional installation.
- If the towed vehicle has been in an accident, it must be properly repaired before attaching the baseplate. Do not install the baseplate if any structural frame damage is found.
- The installer must use all bolts and parts supplied. If running changes were made by the vehicle manufacturer after this kit was designed, some bolts or other fasteners may no longer be the correct size. It is the installer's responsibility to verify this kit is securely fastened to the vehicle.
- Use Loctite® Red on all bolts used to secure this baseplate. Torque all bolts to the specifications found at the end of these instructions. Do not over-torque the bolts or failure may occur.
- The installer must inspect the baseplate to ensure adequate clearance, particularly around hoses, air conditioner lines, radiators, etc. or non-warranty failure may result.
- Roadmaster manufactures many styles of baseplates. If your baseplate has removable arms, they must be removed before driving the vehicle, unless the arms can be pinned or padlocked in place. If not secured, the arms could vibrate out.
- Some motorhome chassis have such a tight turning radius that you can damage your motorhome, towed vehicle, tow bar or baseplate while turning sharply. Before getting on the road, test your turning radius in

an empty parking lot. Turning too sharply could result in non-warranty damage to your towing system, motorhome and/or towed vehicle.

- Do not back up with the towed vehicle attached or non-warranty damage will occur to your towing system or vehicles.
- The safety cables must connect the towing vehicle to the towed vehicle frame to frame, with the cables crossed, with enough slack for sharp turns. See cable instructions for proper routing. Failure to do so will result in non-warranty damage and/or the loss of the towed vehicle.
- This kit is designed for use with ROADMASTER tow bars and ROADMASTER adapters only. Using this kit with other brands, without an approved ROADMASTER adapter, may result in non-warranty damage or injury.
- Receiver extensions and out-of-level towing situations of 3 inches or more. This can cause the system to swing much higher and lower, causing excessive strain on the tow bar, baseplate and frame. That can cause the towing system to fail, causing property damage, personal injury or even death. If you must use a receiver extension or drop hitch to tow, it will reduce your receiver's weight capacity by 1/3 to avoid damaging your system. Never use more than one extension and/or drop hitch, as this will void your warranty.
- Every 3,000 miles, the owner must inspect all mounting points for cracks or fatigue, and check the fasteners for proper torque, according to the bolt torque requirements chart on the last page of these instructions.
- The owner must follow the vehicle manufacturer's instructions to prepare the vehicle for towing. Failure to do so may cause severe damage to the vehicle.
- This baseplate is only warranted for the original installation. Installing a used baseplate on another vehicle is not recommended and will void the warranty.



# BASEPLATE KIT INSTALLATION INSTRUCTIONS

**KIT# 1409-3**

10/20/11  
KS

ROADMASTER, Inc. 6110 NE 127th Ave. Vancouver, WA 98682 1-800-669-9690 fax 360-735-9300 www.roadmasterinc.com

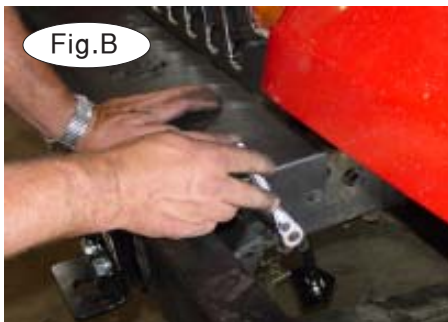

Fig.B



Fig.C

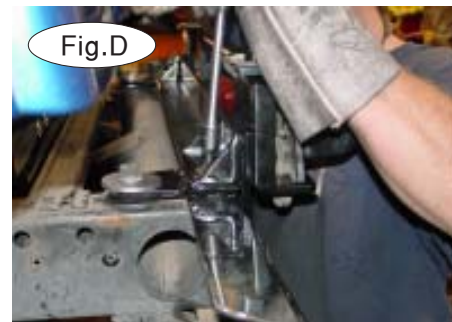

Fig.D

1. **Important:** please use all supplied bolts and parts and read all instructions carefully before beginning this installation. The majority of questions you may have can be answered within the text, and proper installation will ensure safe and secure travel. Now, begin the installation by removing the plastic frame cover if present (four 10mm head bolts) (Fig.B).

2. Working on one side at a time, remove the lower channel bumper mounting bolts (two #55 Torx bolts) (Fig.C).

3. Take a front brace and bolt through the bottom-mounting hole with the original Torx bolt. Leave loose and do the same for the remaining lower mounting bolt (Fig. C).

4. Remove the top bumper mounting bolts on both sides (two #55 Torx bolts). *Note:* some vehicles may be equipped with tow hooks and four top bolts on each side. If these are present, remove the hooks and bolts. Retain the tow hooks and attachment hardware in case the bracket is ever removed.

5. Set the main brace on top of the bumper and bolt the front holes with  $\frac{1}{2}$ " x  $1\frac{3}{4}$ " bolts, lock washers and flat washers (Fig.D).

6. Shim the rear of the brace with the included plate washers and bolt in place with another  $\frac{1}{2}$ " x  $1\frac{3}{4}$ " bolt, lock washer and plate washer on both sides (Fig.D).

7. Install the quick-disconnect base plates or the bar adaptor on the front of the braces using the supplied  $\frac{1}{2}$ " x 2" bolts. Use the bar or base to align the front quick-disconnect plates then torque all mounting bolts to the specifications below (Fig.E).

8. If the plastic frame cover is to be refitted, hold over the top of the frame and braces and mark to fit around the main brace then cut and install with the bolts removed in step 3.

9. Install the tow bar according to the manufacturer's instructions and torque all mounting bolts to the specifications below.

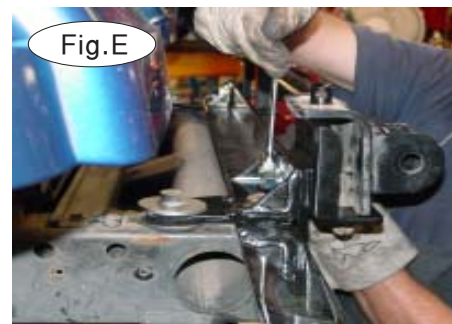

Fig.E

## BOLT TORQUE REQUIREMENTS

Note: The torque values represented below are intended as general guidelines. Torque requirements for specific applications may vary. Roadmaster does not warrant this information to be accurate for all applications and disclaims all liability for any claims or damages which may result from its use.

### STANDARD BOLTS

Thread Size	Grade	Torque
5/16 .....	5 .....	13 ft./lb.
3/8 .....	5 .....	23 ft./lb.
7/16 .....	5 .....	37 ft./lb.
1/2 .....	5 .....	56 ft./lb.
5/8 .....	5 .....	150 ft./lb.

### METRIC BOLTS

Thread Size	Grade	Plated / Unplated
8mm-1.0 .....	8.8 .....	20 ft./lb. 18 ft./lb.
8mm-1.25 .....	8.8 .....	19 ft./lb. 18 ft./lb.
10mm-1.25 .....	8.8 .....	38 ft./lb. 36 ft./lb.
10mm-1.5 .....	8.8 .....	37 ft./lb. 35 ft./lb.

### METRIC BOLTS

Thread Size	Grade	Plated / Unplated
12mm-1.25 .....	8.8 .....	70 ft./lb. 65 ft./lb.
12mm-1.5 .....	8.8 .....	66 ft./lb. 61 ft./lb.
12mm-1.75 .....	8.8 .....	65 ft./lb. 60 ft./lb.
14mm-2.0 .....	8.8 .....	104 ft./lb. 97 ft./lb.

All illustrations and specifications contained herein are based on the latest information available at the time of publication approval.  
ROADMASTER, INC. reserves the right to make changes at any time without notice in material, specification and models or to discontinue models.