



BASEPLATE KIT INSTALLATION INSTRUCTIONS

KIT# 521567-5

08/22/14
KS

ROADMASTER, Inc. 6110 NE 127th Ave. Vancouver, WA 98682 360-896-0407 fax 360-735-9300 www.roadmasterinc.com

Important
Note: this bracket will not accommodate the Guardian rock shield, some models of the Tow Defender, or the StowMaster and StowMaster All Terrain tow bars.

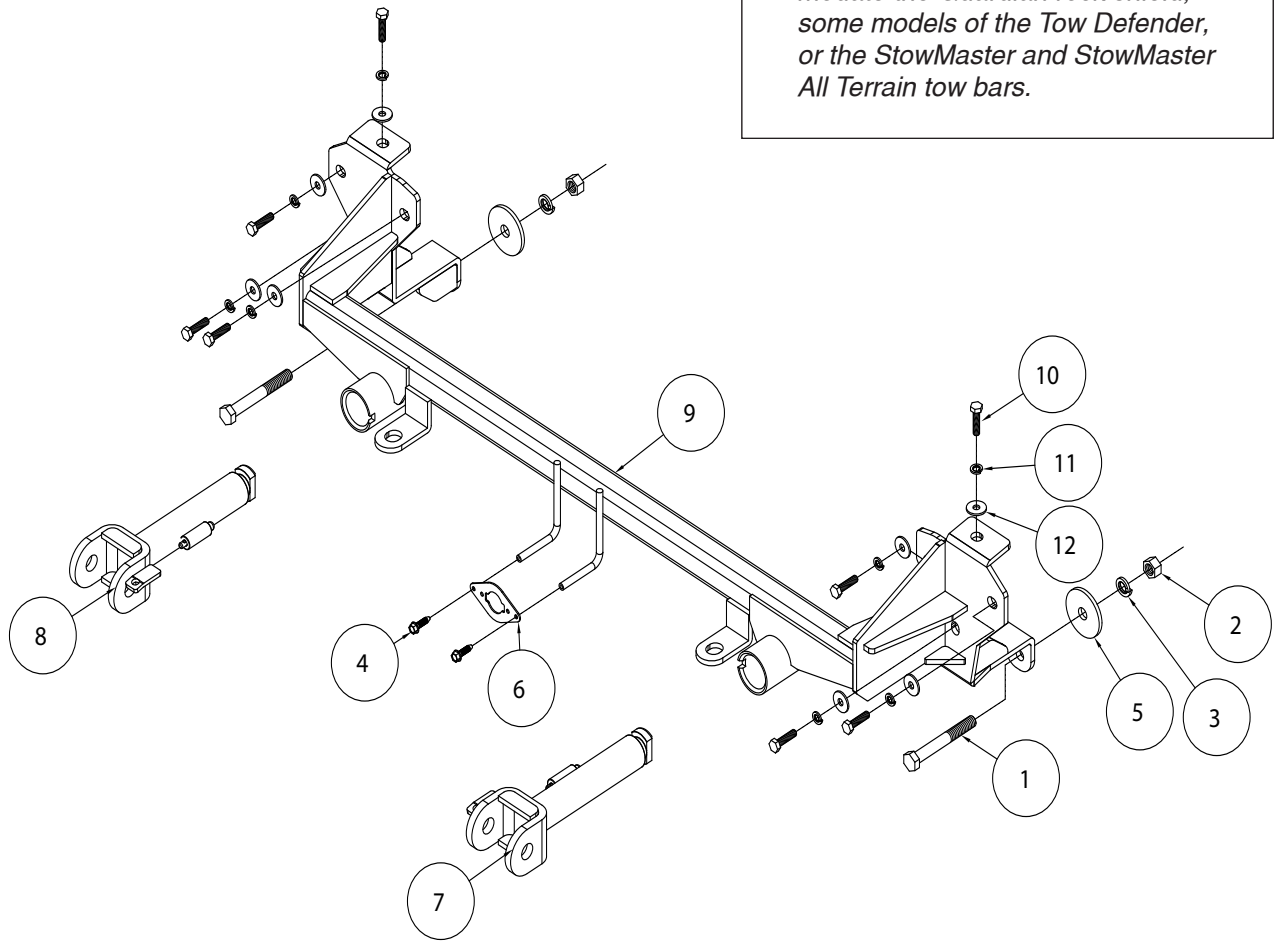

ITEM	QTY	NAME	MATERIAL
1	2	1/2" x 4 1/2" BOLT	350106-00
2	2	1/2" HEX NUT	350258-00
3	2	1/2" LOCK WASHER	350309-00
4	2	#10 x 3/4" SELF TAPPING SCREW	350247-35
5	2	1/2" PLATE WASHER	A-003086
6	1	WIRE PLUG PLATE	A-003801
7	1	DRIVER SIDE ARM	C-002383
8	1	PASSENGER SIDE ARM	C-002384
9	1	MAIN RECEIVER	C-002385
10	8	8mm x 1.25 x 30mm BOLT	356001-00
11	8	8mm LOCK WASHER	355705-00
12	8	5/16" FLAT WASHER	350302-00



BASEPLATE KIT INSTALLATION INSTRUCTIONS

KIT# 521567-5

08/22/14
KS

ROADMASTER, Inc. 6110 NE 127th Ave. Vancouver, WA 98682 360-896-0407 fax 360-735-9300 www.roadmasterinc.com

This is one of our EZ5 series brackets, which allows the visible front portion of the bracket to be easily removed from the front of the vehicle (Fig.A and Fig.B). The bracket consists of a main receiver brace, two removable front braces, and a hardware pack.

The main receiver brace mounts to the frame rails and the removable front braces install in the main receiver brace.

Before starting the installation, lay out the kit components in order, as they will be used. This will give you a visual idea of how the components work, and will also confirm that everything is present and accounted for.



IMPORTANT: All baseplates *must* be assembled with all the bolts left loose for final adjustment and positioning (before tightening) unless otherwise instructed. All bolts *must* be torqued for proper strength. If more than one bolt is used per fastening point, the diagram may only show one. Use flat washers over all slotted holes and lock washers on all fasteners.

WARNING

Failure to heed these warnings or follow the installation instructions may result in a voided warranty, loss of towed vehicle, personal injury or death.

- Do not weld or modify this baseplate or its components. Welding or modification will void the warranty.
- Do not use this document as a basis to design/fabricate a baseplate, as it may not show all parts or structural components.
- We strongly recommend professional installation.
- If the towed vehicle has been in an accident, it must be properly repaired before attaching the baseplate. Do not install the baseplate if any structural frame damage is found.
- The installer must use all bolts and parts supplied. If running changes were made by the vehicle manufacturer after this kit was designed, some bolts or other fasteners may no longer be the correct size. It is the installer's responsibility to verify this kit is securely fastened to the vehicle.
- Use Loctite® Red on all bolts used to secure this baseplate. Torque all bolts to the specifications found at the end of these instructions. Do not over-torque the bolts or failure may occur.
- The installer must inspect the baseplate to ensure adequate clearance, particularly around hoses, air conditioner lines, radiators, etc. or non-warranty failure may result.
- Roadmaster manufactures many styles of baseplates. If your baseplate has removable arms, they must be removed before driving the vehicle, unless the arms can be pinned or padlocked in place. If not secured, the arms could vibrate out.
- Some motorhome chassis have such a tight turning radius that you can damage your motorhome, towed vehicle, tow bar or baseplate while turning sharply. Before getting on the road, test your turning radius in an empty parking lot. Turning too sharply could

result in non-warranty damage to your towing system, motorhome and/or towed vehicle.

- Do not back up with the towed vehicle attached or non-warranty damage will occur to your towing system or vehicles.
- The safety cables must connect the towing vehicle to the towed vehicle frame to frame, with the cables crossed, with enough slack for sharp turns. See cable instructions for proper routing. Failure to do so will result in non-warranty damage and/or the loss of the towed vehicle.
- This kit is designed for use with ROADMASTER tow bars and ROADMASTER adapters only. Using this kit with other brands, without an approved ROADMASTER adapter, may result in non-warranty damage or injury.
- Receiver extensions and out-of-level towing situations of 3 inches or more. This can cause the system to swing much higher and lower, causing excessive strain on the tow bar, baseplate and frame. That can cause the towing system to fail, causing property damage, personal injury or even death. If you must use a receiver extension or drop hitch to tow, it will reduce your receiver's weight capacity by 1/3 to avoid damaging your system. Never use more than one extension and/or drop hitch, as this will void your warranty.
- Every 3,000 miles, the owner must inspect all mounting points for cracks or fatigue, and check the fasteners for proper torque, according to the bolt torque requirements chart on the last page of these instructions.
- The owner must follow the vehicle manufacturer's instructions to prepare the vehicle for towing. Failure to do so may cause severe damage to the vehicle.
- This baseplate is only warranted for the original installation. Installing a used baseplate on another vehicle is not recommended and will void the warranty.



BASEPLATE KIT INSTALLATION INSTRUCTIONS

KIT# 521567-5

08/22/14
KS

ROADMASTER, Inc. 6110 NE 127th Ave. Vancouver, WA 98682 360-896-0407 fax 360-735-9300 www.roadmasterinc.com

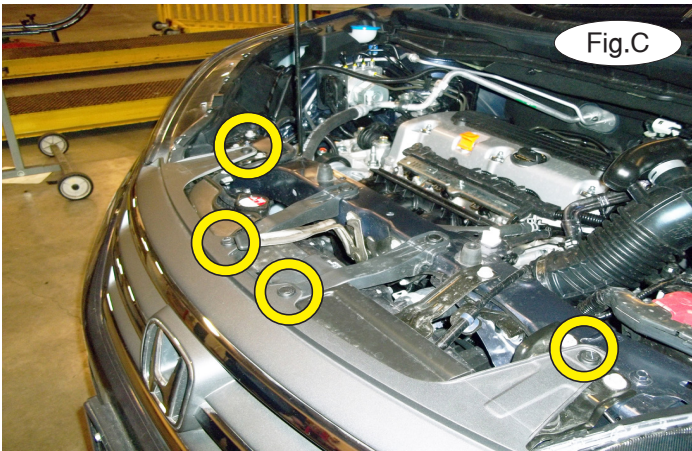

1. **Important:** please use all supplied bolts and parts and read all instructions carefully before beginning this installation. The majority of questions you may have can be answered within the text, and proper installation will ensure safe and secure travel. Now, begin the installation. Remove four plastic fasteners attaching the grille to the radiator support (Fig.C).

2. On each side, remove one 10mm (head) bolt and one plastic fastener attaching the bottom of the fascia to the fender liner (Fig.D). Now, remove four plastic fasteners attaching the fascia to the splash shield (Fig.E).



3. On each side, remove one Philips screw and two plastic fasteners from the inside of the fender liner (Fig.F).

4. On each side, pull back the fender liner and remove one plastic fastener attaching the lower trim to the fascia (Fig.G).





BASEPLATE KIT INSTALLATION INSTRUCTIONS

KIT# 521567-5

08/22/14
KS

ROADMASTER, Inc. 6110 NE 127th Ave. Vancouver, WA 98682 360-896-0407 fax 360-735-9300 www.roadmasterinc.com



5. On each side, carefully pull the lower fascia from the fender trim (Fig.H), and the fender trim from the fender (Fig.I), releasing three clips.

6. On each side, remove one Philips screw from the corner of the fascia (Fig.J).



7. With a firm grip on the grille, pull hard and straight out on it to release it from the two yellow clips near the headlights and the four yellow clips along the bottom of the grille (Fig.K). On each side, pull out on corner of the fascia to remove it from the locking strip as indicated by the yellow lines in Figure L) and then a screwdriver to release the yellow clip shown in Figure M.

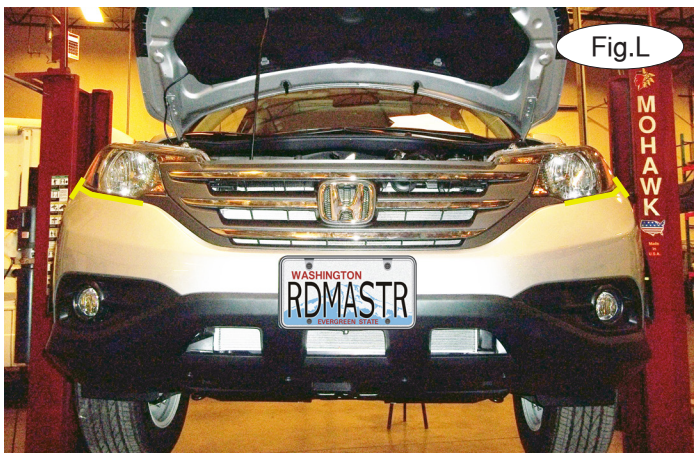



BASEPLATE KIT INSTALLATION INSTRUCTIONS

KIT# 521567-5

08/22/14
KS

ROADMASTER, Inc. 6110 NE 127th Ave. Vancouver, WA 98682 360-896-0407 fax 360-735-9300 www.roadmasterinc.com

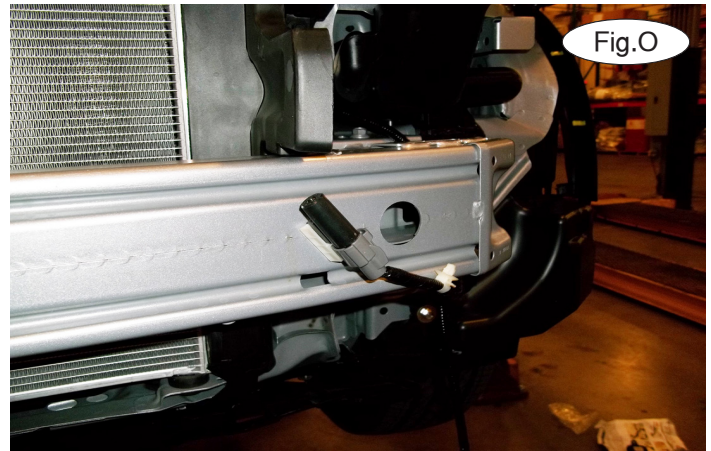
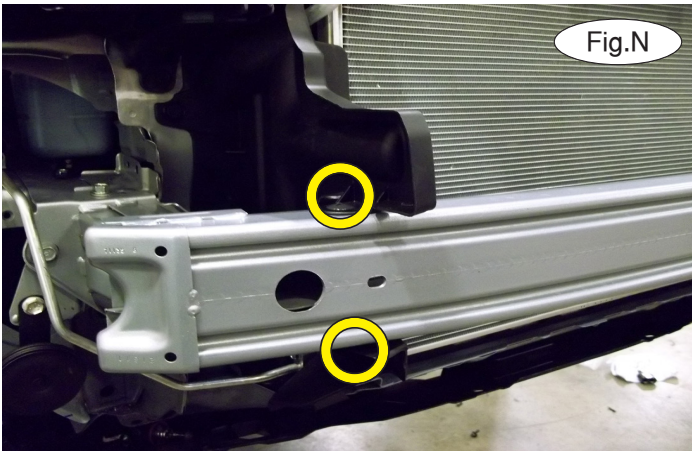

8. Now, pull out and forward to remove the fascia. Disconnect the fog lights, if the vehicle is so equipped.
9. Remove two clips attaching the passenger side air dam to the bumper core (Fig.N) and one attaching the driver's side air dam.

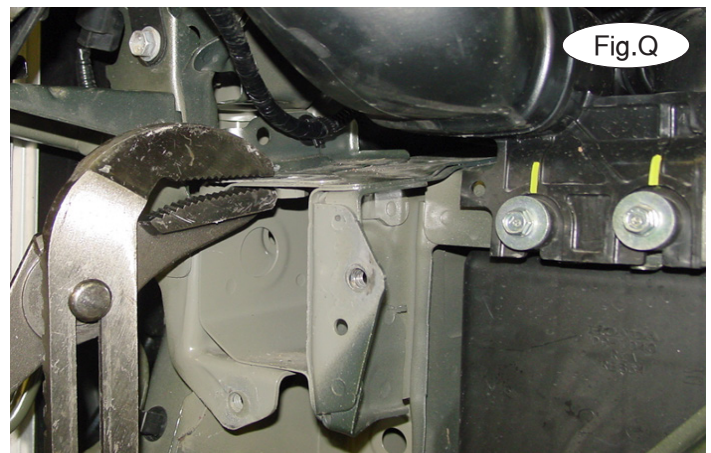
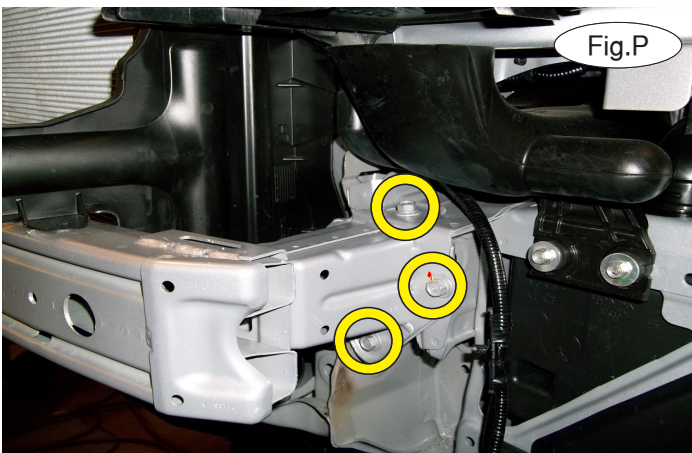

10. Disconnect the ambient temperature sensor from the bumper core (Fig.O). Let it hang down for now.
11. On each side, remove four 12mm (head) bolts attaching the bumper core to the frame (Fig.P). *Note:* only three are shown. The fourth bolt is to the inside of the frame rail.
Now, remove the bumper core. The bumper core will not be replaced. *Note:* retain the bumper core and attachment hardware for replacement in case the bracket is ever removed.
12. On each side, use a pair of channel locks to bend flush the tab located on the top of the frame rail to allow clearance for the main receiver brace (Fig.Q).



BASEPLATE KIT INSTALLATION INSTRUCTIONS

KIT# 521567-5

08/22/14
KS

ROADMASTER, Inc. 6110 NE 127th Ave. Vancouver, WA 98682 360-896-0407 fax 360-735-9300 www.roadmasterinc.com

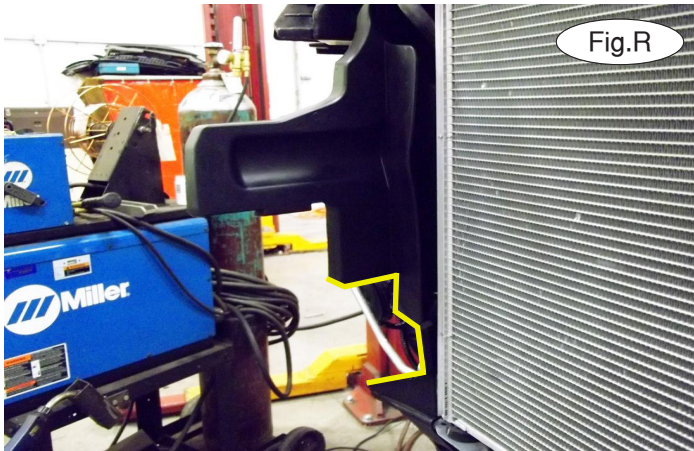

13. Trim the passenger side air dam as shown in Figure R and the driver's side air dam as shown in Figure S.

14. Place the main receiver brace over the ends of the frame rails and on each side, bolt into the bumper core mounting points using the four supplied 8mm x 1.25 x 30mm bolts, 8mm lock washers and 5/16" flat washers (Fig.T). Make certain that the cooling line does not contact the main receiver brace on the passenger side. If it does, bend it down and slightly out of the way (Fig.U). *Note:* ensure proper alignment, as the bolts will receive Loctite® Red and will be torqued at the end of these instructions.

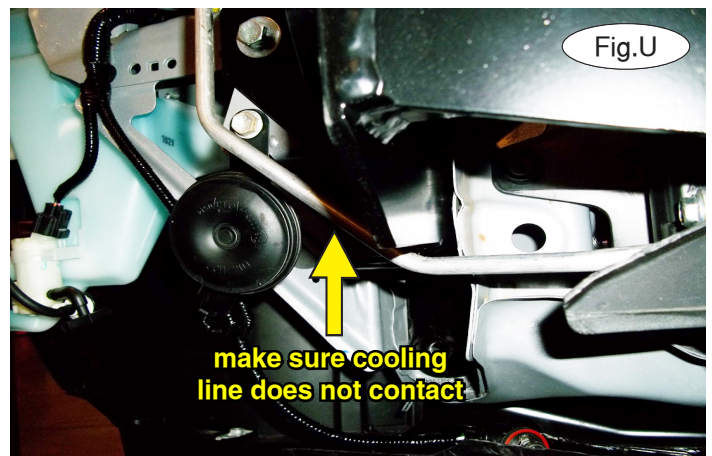
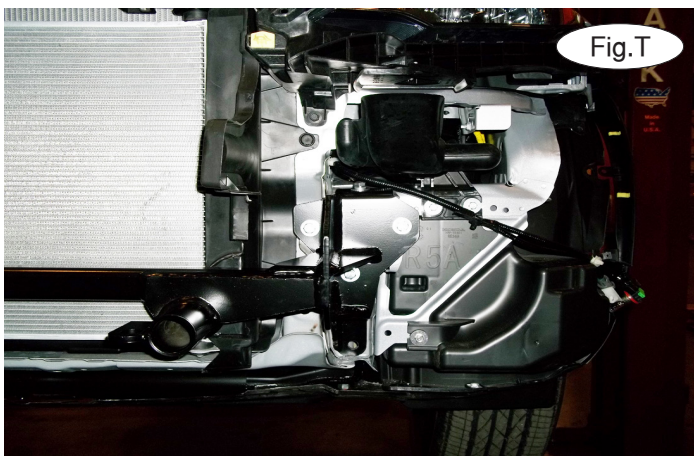

15. On the driver's side only, remove four plastic fasteners attaching the fender liner to the frame (Fig.V).





BASEPLATE KIT INSTALLATION INSTRUCTIONS

KIT# 521567-5

08/22/14
KS

ROADMASTER, Inc. 6110 NE 127th Ave. Vancouver, WA 98682 360-896-0407 fax 360-735-9300 www.roadmasterinc.com

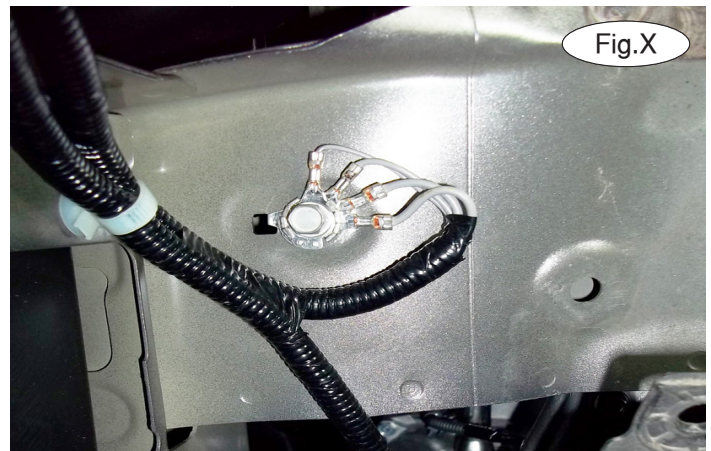
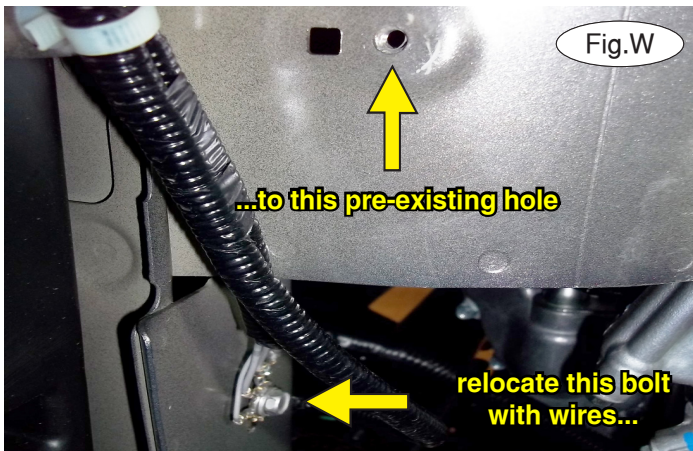

16. Now, pull back the fender liner and remove the 10mm (head) bolt with wires (Fig.W). Relocate it to the pre-existing threaded hole about six inches up on the side of the frame (Fig.X).

17. Working on the driver's side only, remove the 17mm (head) subframe bolt located directly beneath the driver's side lower mounting point of the receiver on the under side of the vehicle. **Warning: if you remove both subframe bolts at the same time, the subframe may detach from the vehicle. One subframe bolt must be installed on the vehicle and torqued to the manufacturer's specifications at all times.**

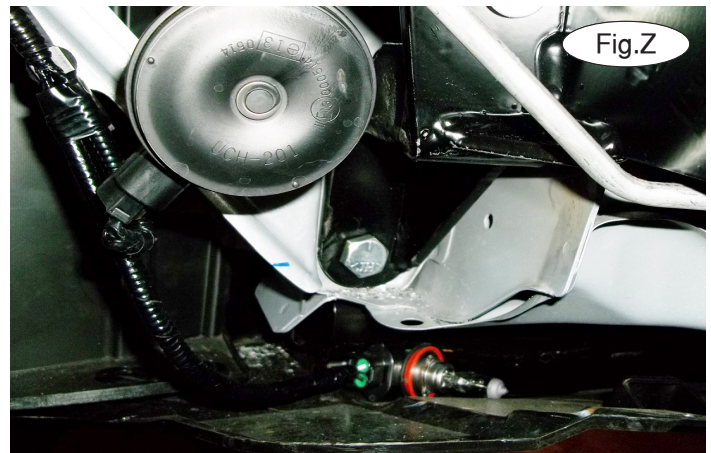
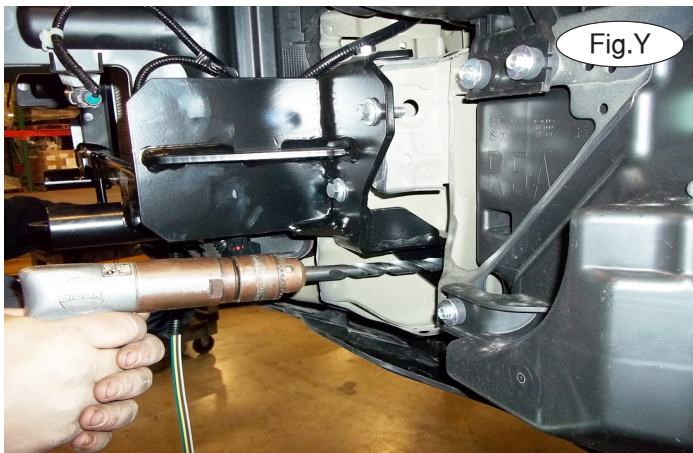

18. Working on the driver's side only, using the lower mounting point of the main receiver brace as a template, drill a 1/2" hole through the two layers of the frame rail (Fig.Y). *Note:* use caution to avoid drilling into the cooling line.

Now, bolt through the lower mounting point using the supplied 1/2" x 4 1/2" bolt, and finish with a 1/2" plate washer, lock washer and nut (Fig.Z).

19. Reinstall the 17mm (head) bolt you removed in step 17, ensuring that the bolt does not contact the 1/2" x 4 1/2" bolt installed in step 18. If it contacts it at all, cut off the tip of the subframe bolt using a cut-off wheel. Tighten all bolts to the bolt torque requirements found at the end of these instructions. *Note:* use Loctite® Red on all nuts and bolts.

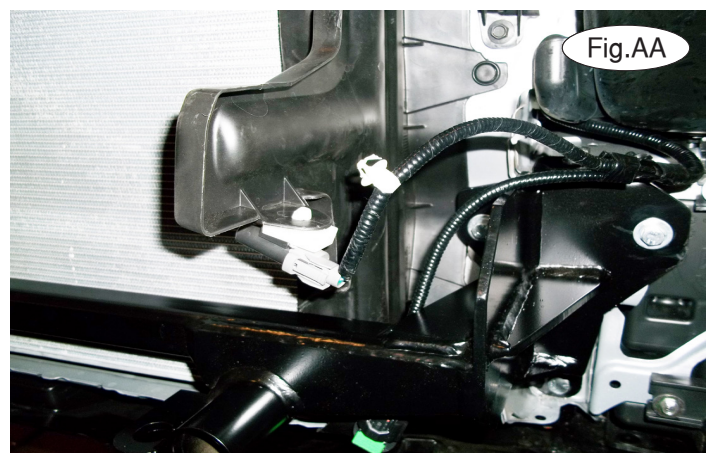

20. Now, repeat steps 17 through 19 for the passenger side of the vehicle.

21. Attach the ambient temperature sensor to the driver's side air dam as shown in Figure AA.

22. Reinstall the fascia, reversing steps 1 through 9.



BASEPLATE KIT INSTALLATION INSTRUCTIONS

KIT# 521567-5

08/22/14
KS

ROADMASTER, Inc. 6110 NE 127th Ave. Vancouver, WA 98682 360-896-0407 fax 360-735-9300 www.roadmasterinc.com



21. **Note: the following four images are for illustration purposes only, as your specific application may be slightly different.**

The spring-loaded pin on the removable arm snaps into a notch on the receiver, locking the removable arm into its final towing position. Before inserting each arm into the receiver, verify that the spring is working by ensuring that the spring-loaded pin moves easily back and forth within the barrel when pulled and that it can be pulled flush with the face of the barrel (Fig.BB and Fig.CC).

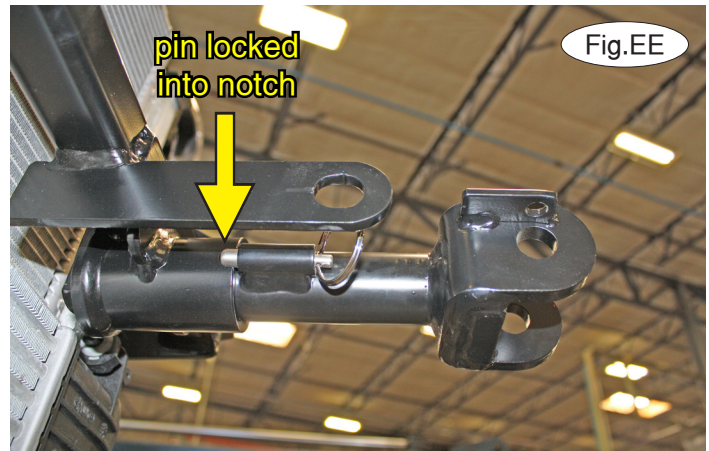
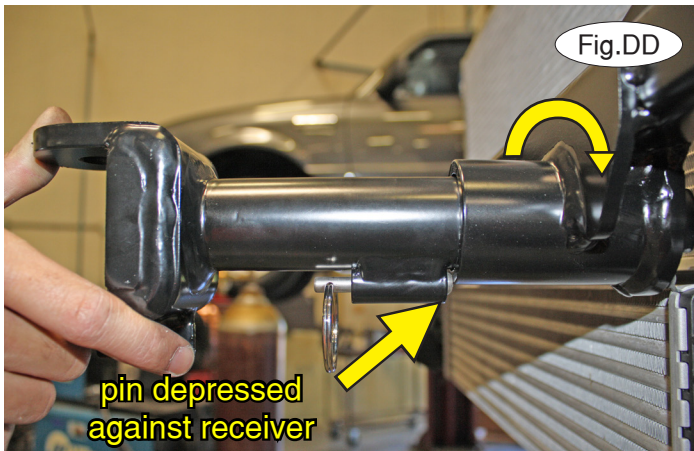

22. On each side, insert the removable front bracket arm into the front receiver 90 degrees from its final towing position, depressing the spring-loaded pin against the receiver (Fig.DD). Now, twist back 90 degrees until the spring-loaded pin snaps into place in the notch on the receiver, locking the arm into place in its final towing position (Fig.EE).

Please note: it is the owner's responsibility to ensure the locking of the pins before towing. Otherwise, failure of the towing system will result.

23. Install the tow bar to the mounting bracket according to the manufacturer's instructions.



BASEPLATE KIT INSTALLATION INSTRUCTIONS

KIT# 521567-5

08/22/14
KS

ROADMASTER, Inc. 6110 NE 127th Ave. Vancouver, WA 98682 360-896-0407 fax 360-735-9300 www.roadmasterinc.com

IMPORTANT!

Safety cables are required by law. When towing, connect safety cables to the safety cable tabs illustrated in Figure EE. Make certain there is adequate slack in the cables to allow a full turning radius; otherwise, damage will result. If necessary, longer cables or cable extensions are available.

Note: if the bracket is so equipped, the holes in the alignment tabs which are welded to the arms and main receivers are for padlocks only. Under no circumstances should you bolt the alignment tabs together. Bolting the alignment tabs together may result in non-warranty damage to the bracket.

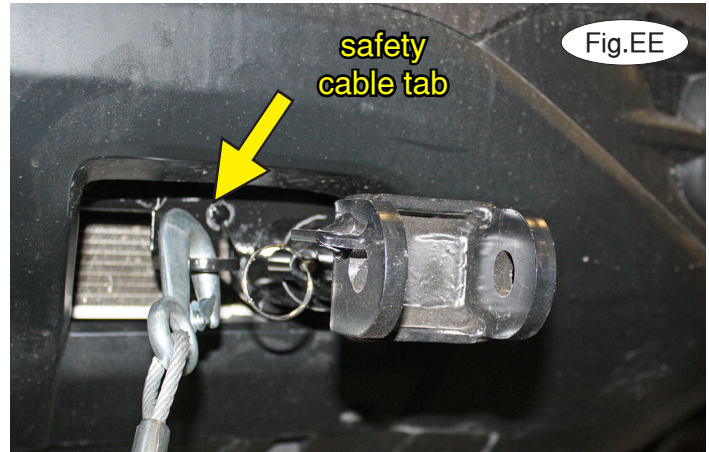

Three options for attaching the wiring plug to the main receiver brace

For six-wire plugs: use the two supplied 3/4" self-tapping screws to attach the electrical plug directly to the rods on the front of the main receiver brace.

For four-wire round plugs: attach to the plug mounting plate and then use the two supplied 3/4" self-tapping screws to attach the mounting plate to the rods on the front of the main receiver brace.

For four-wire flat plugs: place the plug through the mounting plug plate, and then secure it using the supplied zip tie on the front of the plug (Fig.FF). Use the two supplied 3/4" self-tapping screws to attach the mounting plate to the rods on the front of the main receiver brace.

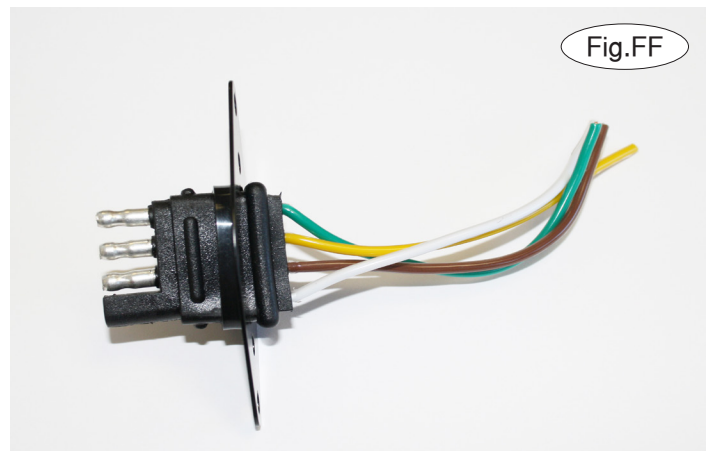

BOLT TORQUE REQUIREMENTS

Note: The torque values represented below are intended as general guidelines. Torque requirements for specific applications may vary. Roadmaster does not warrant this information to be accurate for all applications and disclaims all liability for any claims or damages which may result from its use.

STANDARD BOLTS

Thread Size	Grade	Torque
5/16-18	5	13 ft./lb.
3/8-16	5	23 ft./lb.
7/16-14	5	37 ft./lb.
1/2-13	5	57 ft./lb.
5/8-11	5	112 ft./lb.

METRIC BOLTS

Thread Size	Grade	Torque
6mm-1.0	8.8	6 ft./lb.
8mm-1.0	8.8	18 ft./lb.
8mm-1.25	8.8	16 ft./lb.
10mm-1.25	8.8	36 ft./lb.
10mm-1.5	8.8	31 ft./lb.

METRIC BOLTS

Thread Size	Grade	Torque
12mm-1.25	8.8	64 ft./lb.
12mm-1.5	8.8	60 ft./lb.
12mm-1.75	8.8	55 ft./lb.
14mm-2.0	8.8	88 ft./lb.

All illustrations and specifications contained herein are based on the latest information available at the time of publication approval. ROADMASTER, INC. reserves the right to make changes at any time without notice in material, specification and models or to discontinue models.